

014227

22/9/78



PERMIT

WF

Application No.

Permit No.

D. & P. No.

BOROUGH OF ELTHAM**APPLICATION FOR PERMIT****220 BUILDING AND/OR DRAINAGE & PLUMBING**

I hereby apply for a permit to carry out Building and/or Drainage and Plumbing work as described hereunder in accordance with the plans and specifications deposited herewith in duplicate.

NAME OF OWNER: A. R. HARTLEYADDRESS OF OWNER: 18 RD. ELTHAM.

LEGAL DESCRIPTION OF PROPERTY:

VALUATION NO.: Lot: 22 23 D.P./S: 11369. Section:Address of Property: WILLOWBROOK ST.DESCRIPTION OF WORK TO BE DONE: NEW RESIDENCE

To build/alter/repair a

PROPOSED USE OF BUILDING: DWELLING.

: Total Floor Area

M³

N.B. The purpose for which each part of the building is to be used must be indicated on the plans.

NAME OF BUILDER: G. MORRISYADDRESS: 23 OPUNAKE RD STRATFORD.NAME OF DRAINLAYER: G. FOWLER.ADDRESS: HIGH ST ELTHAM.

NAME OF PLUMBER:

ADDRESS:

ESTIMATED VALUES:**FEES PAYABLE**

Building

24500Plumbing &
Drainage150.00**TOTAL**24,650.0064.002.0026.00

Building Res. Levy

Water Connection

Sewer Connection

Kerb/Footpath Deposit

100.00

Underground Power Fee

Scale of Fees
Overleaf**TOTAL FEES:**\$192.00Signature of Applicant: AM HartleyDate: 22. Sept. 1976

Fees Paid \$

Payee:

Rec. No. 9703.Date: 22/9/78

BUILDING PERMIT FEES			
ESTIMATED VALUE OF BUILDING WORK			
			FEE
	Up to		\$ c.
\$21	to	\$20	50
\$201	to	\$200	1.00
\$401	to	\$400	2.00
\$601	to	\$600	3.00
\$801	to	\$800	4.00
\$1,001	to	\$1,000	5.00
\$1,201	to	\$1,200	6.00
\$1,401	to	\$1,400	7.00
\$1,601	to	\$1,600	8.00
\$1,801	to	\$1,800	9.00
\$2,0001	to	\$2,000	10.00
\$2,501	to	\$2,500	12.00
\$3,001	to	\$3,000	14.00
\$3,501	to	\$3,500	16.00
\$4,001	to	\$4,000	18.00
\$5,001	to	\$5,000	21.00
\$6,001	to	\$6,000	24.00
\$7,001	to	\$7,000	27.00
\$8,001	to	\$8,000	30.00
\$9,001	to	\$9,000	33.00
\$10,001	to	\$10,000	36.00
\$12,001	to	\$12,000	40.00
\$14,001	to	\$14,000	44.00
\$16,001	to	\$16,000	48.00
\$18,001	to	\$18,000	52.00
\$20,001	to	\$20,000	56.00
\$25,001	to	\$25,000	64.00
\$30,001	to	\$30,000	72.00
\$35,001	to	\$35,000	80.00
\$40,001	to	\$40,000	88.00
\$50,001	to	\$50,000	98.00
\$60,001	to	\$60,000	108.00
\$70,001	to	\$70,000	118.00
\$80,001	to	\$80,000	128.00
\$90,001	to	\$90,000	138.00
\$100,001	to	\$100,000	148.00
\$120,001	to	\$120,000	158.00
\$140,001	to	\$140,000	168.00
\$160,001	to	\$160,000	178.00
\$180,001	to	\$180,000	188.00
		\$200,000	198.00

FEES PAYABLE FOR SPECIAL DUTIES

NATURE OF DUTY	FEES
For inspection required in the case of proposed structural alterations before plans are submitted for approval	\$2.00
For inspecting every detached stove, furnace, oven, close fire or forge erected subsequently to the building	\$1.00
For inspecting old timber before re-using same in a new building	\$2.00
For any inspection that may be deemed necessary in connection with any building or work in respect of which no fees has otherwise been paid	\$0.50

PLUMBING & DRAINAGE PERMIT FEES

Payment for permit fees based on the following scale must accompany this application.

ESTIMATED VALUE OF WORK			FEE PAYABLE
	Up To		
\$11	To	\$10	10c
\$21	To	\$20	25c
\$51	To	\$50	50c
\$101	To	\$100	\$1
\$201	To	\$200	\$2
\$301	To	\$300	\$3
		\$400	\$4

plus \$1 for every
\$200 or part thereof
in excess of \$400.

BUILDING RESEARCH LEVY

A levy of \$1.00 per thousand or part thereof of the whole value (including Plumbing and Drainage Fees), applies to all buildings, valued at \$3,000 or more, e.g. \$3,000 value, \$3.00 Levy, \$3,050 Value — \$4.00 Levy.

ADDITIONAL FEES PAYABLE

Water Connection
Sewer Connection
Kerb/Footpath Deposit
Underground Power Fee
Footpath Crossing

ELTHAM BOROUGH COUNCIL

APPLICATION TO INSTALL A MOTORCROSSING

PART A

I, _____, hereby submit an application for the installation, by the Eltham Borough Council, of a motorcrossing at the property situated at _____, and I tender the sum as detailed below for payment in full of the said crossing.

.....

Signature of Applicant

/ /

PART B

I, _____, hereby apply to the Eltham Borough Council for their approval to install a motorcrossing at the property situated at _____, and I tender the sum of \$20.00 as payment in full for the plans, specifications and related inspections of the motorcrossing by the Borough Engineer. Further, I agree to the following conditions:-

- i. That the motorcrossing be constructed in strict accordance with the plans and specifications supplied.
- ii. That should the motorcrossing, when completed, not meet with the Borough Engineer's satisfaction then all associated costs borne by Council to upgrade the motorcrossing to required standard, be met by the applicant.

.....

Signature of Applicant

/ /

<u>FEES:</u>	Dish Type	\$21.54/square metre
	Dish Type (Heavy Duty)	\$28.23/square metre
	Bridge Type	\$30.57/square metre
	Bridge Type (Heavy Duty)	\$39.20/square metre

TYPE OF CROSSING

AREA OF CROSSING

FEES PAYABLE

RECEIPT NO.

APPROVED

/ /

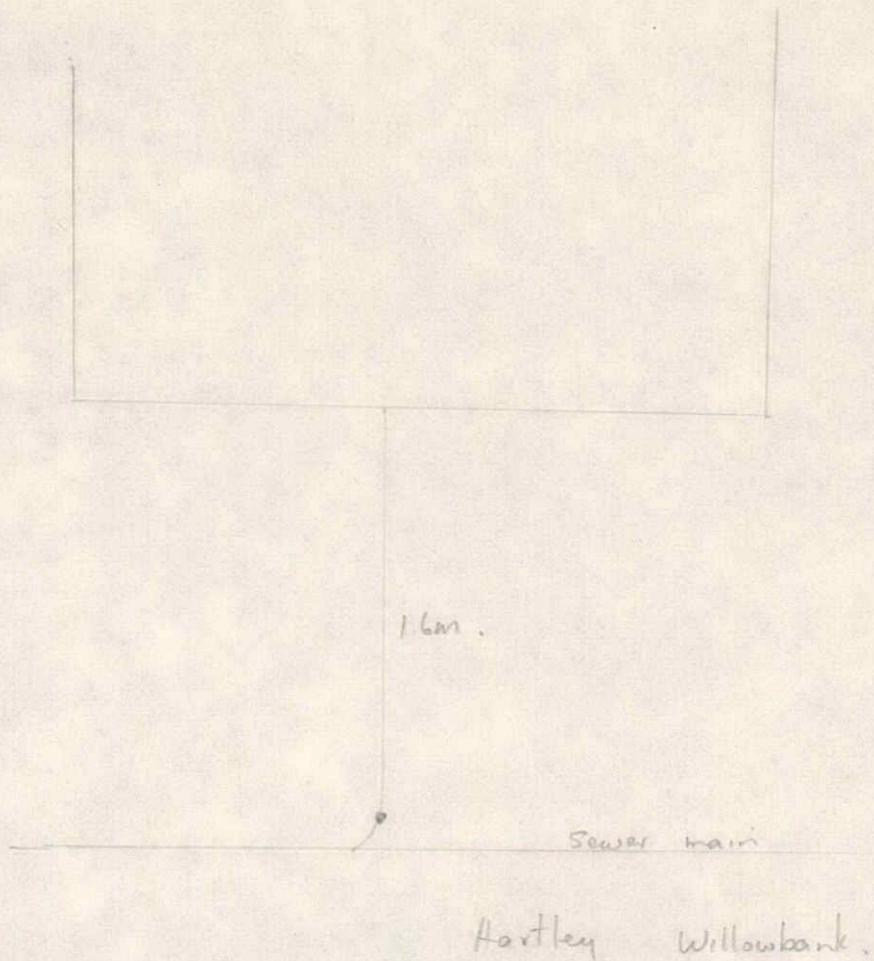

12 200/224/28

not to scale

ELTHAM BOROUGH COUNCIL

Application for Permit for Sanitary Plumbing or Drainage Work

To the Engineer,
Eltham Borough Council,
P.O. Box 13,
ELTHAM.

I, the undersigned W. Lawler of 253 High St Eltham
hereby apply for permission for the work described herein, and set out in the plans attached hereto,
to be carried out in the premises situated in

Lot No. 22-23 Section No. D.P. 11369
Block, or S.D. Ngami, or S.O.

Name and address of person for whom work is to be carried out:

Ray Hartley
Willow Brook Drive

Name and address of registered plumber or other person entitled to do the work:

W. Lawler 253
High St Eltham

Value of Proposed Work, including Materials —
Estimated Value of:

(a) Plumbing
(b) Drainage
Total

Signature W. Lawler

Dated this 8 day of December 19 78

* Complete whichever is applicable.

NAME and ADDRESS

OF OWNER:

Mr. Roy Hartley
Willow Bank Drive Elkhorn

APPLICATION APPROVED

DATE

PERMIT ISSUED No.

DATE

RECEIPT No.

FRONTAGE TO

Willow Bank Drive

STREET/ROAD

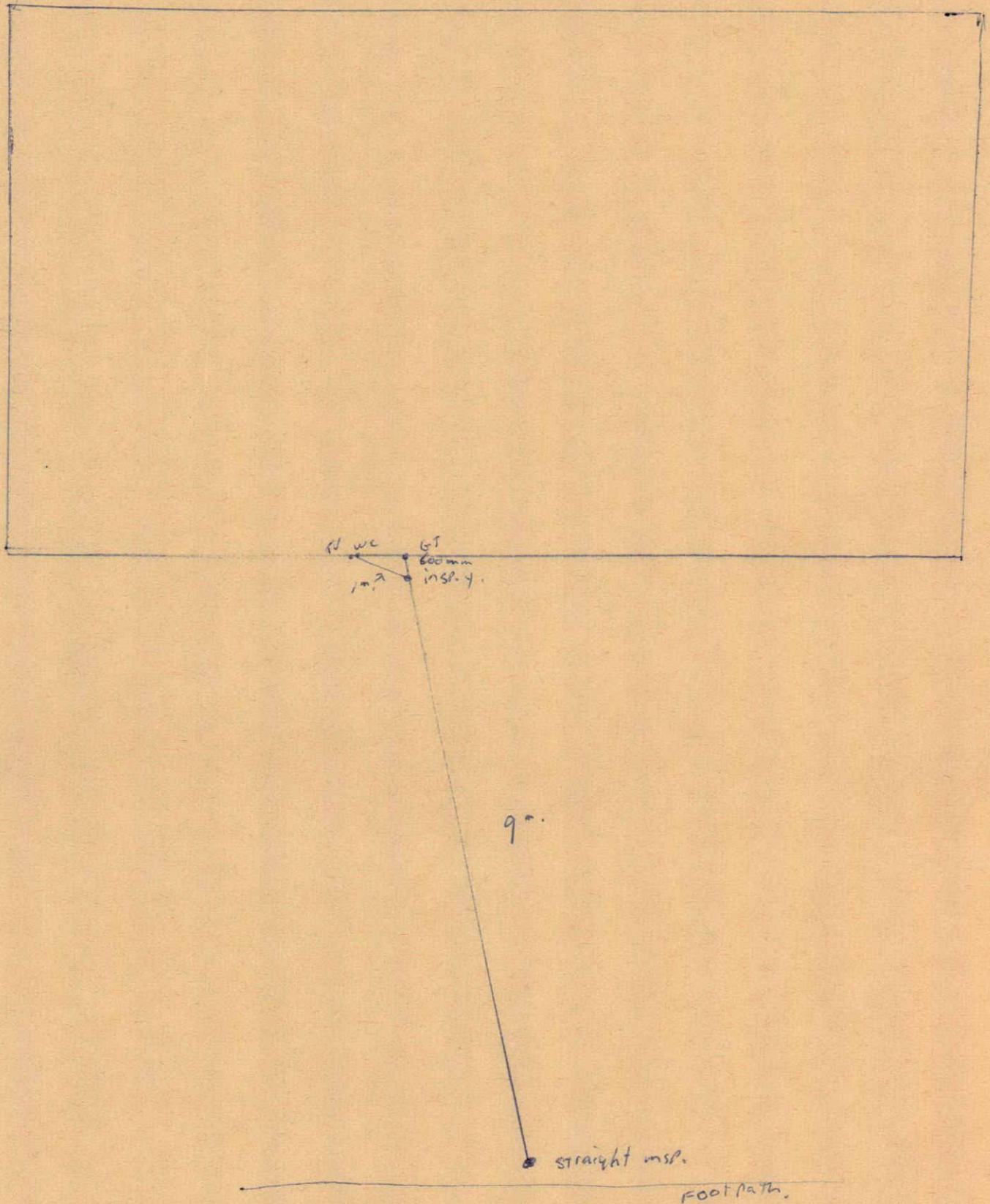

SANITARY DRAINAGE PLAN TO SHOW ALL JUNCTIONS, Y CONNECTIONS AND
TERMINAL VENTS.

PERMIT FEES

Payment for permit fees based on the following scale must accompany this application.

Estimated Value of Work					Fee Payable
Not Exceeding	\$ 10				10c
Exceeding	\$ 10	but	not exceeding	\$ 20	25c
	\$ 20			\$ 50	50c
"	\$ 50	"	"	"	\$1
"	\$ 100	"	"	"	\$2
"	\$200	"	"	"	\$3
"	\$300	"	"	"	\$4
"	\$400	"	"	"	\$4 plus \$1 for every \$200
"	\$400	"	"	"	or part thereof in excess
"		"	"	"	of \$400.

1220/224/28

FRONTAGE TO

3 Willow Bank Drive

STREET/ROAD

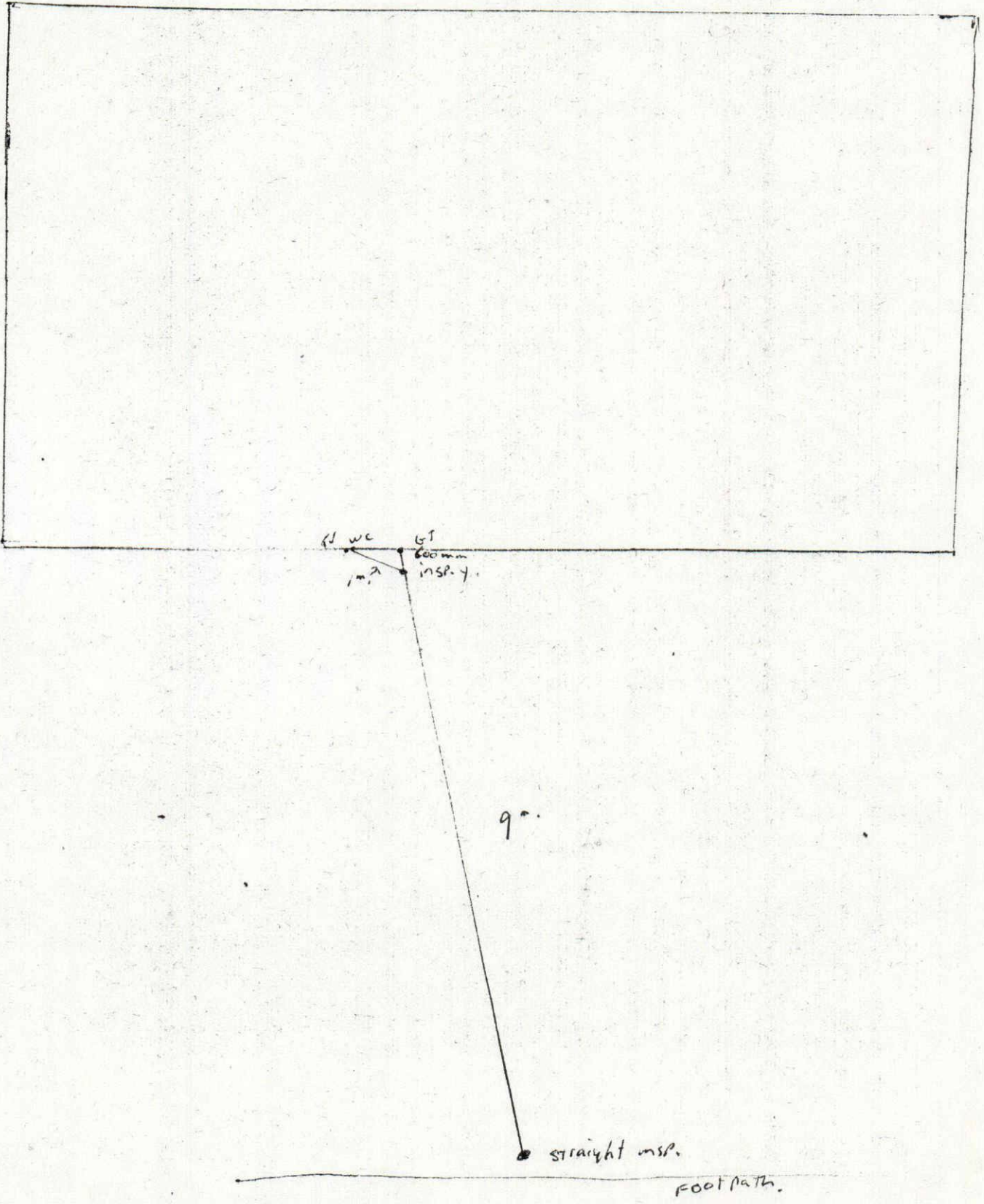

SANITARY DRAINAGE PLAN TO SHOW ALL JUNCTIONS, Y CONNECTIONS AND
TERMINAL VENTS.

1220/224/28

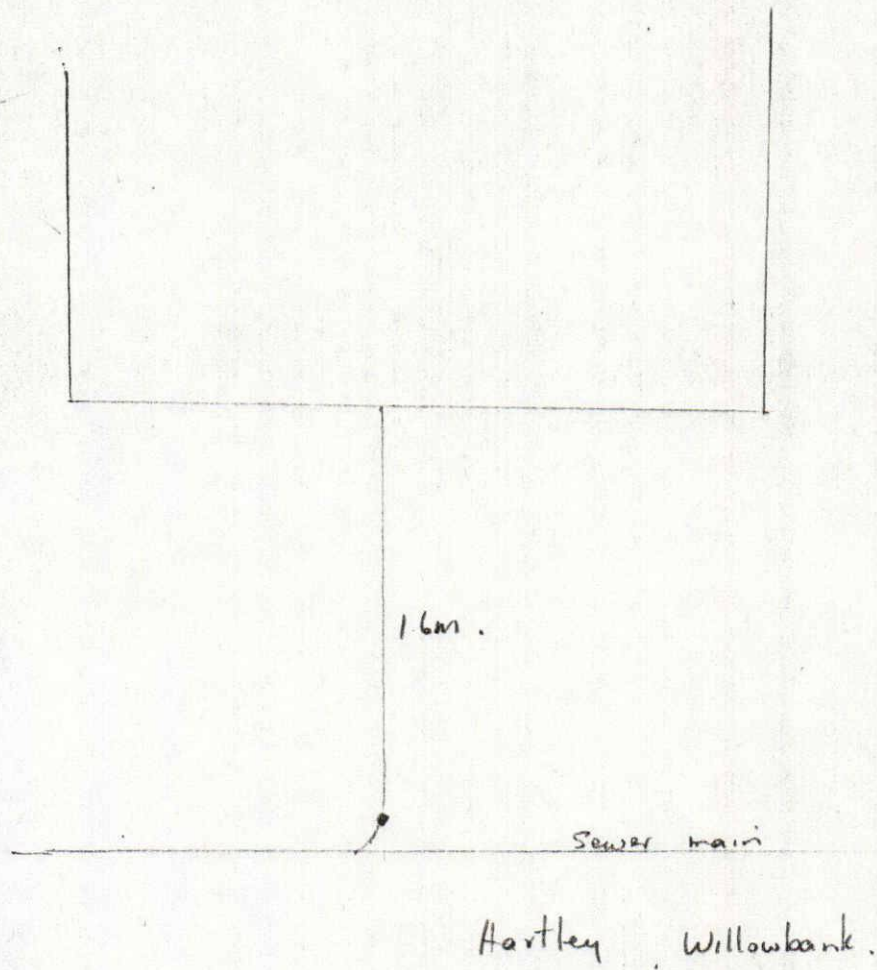

12200/224/28

not to scale

Blocks

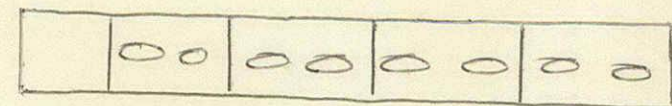

Reinforcing every inches.
Reinforcing diameter

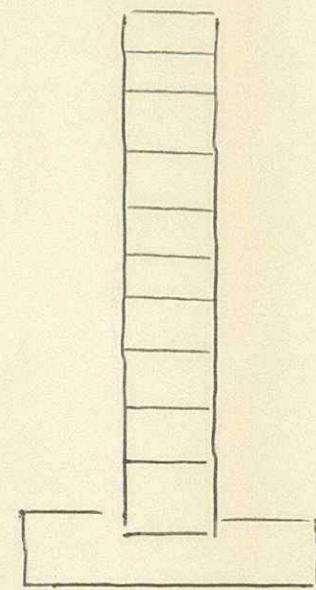

Bond Beam
Middle and Top Row using diameter
Reinforcing rods.

footing foundation



Pile Spacing

(Pile Area)

(foundations only at existing
ground level)

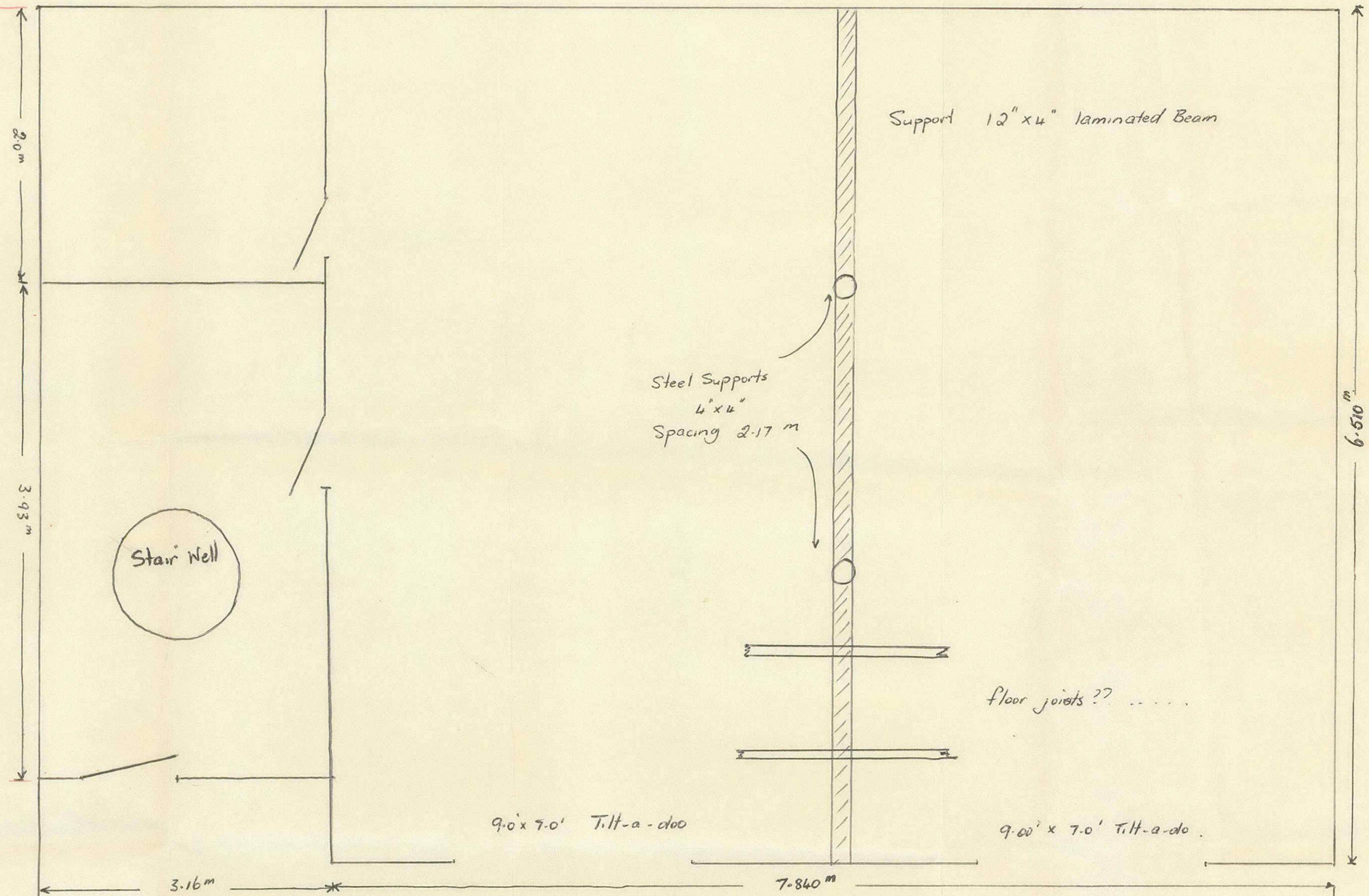

(Patio)

Block Wall
Continued as
Retaining Wall
for Patio.

Basement

Outer Wall - Concrete blocks
Inner Partition Wall - Timber

Actual measurements of block walls to be
reduced by cm² - so as below.

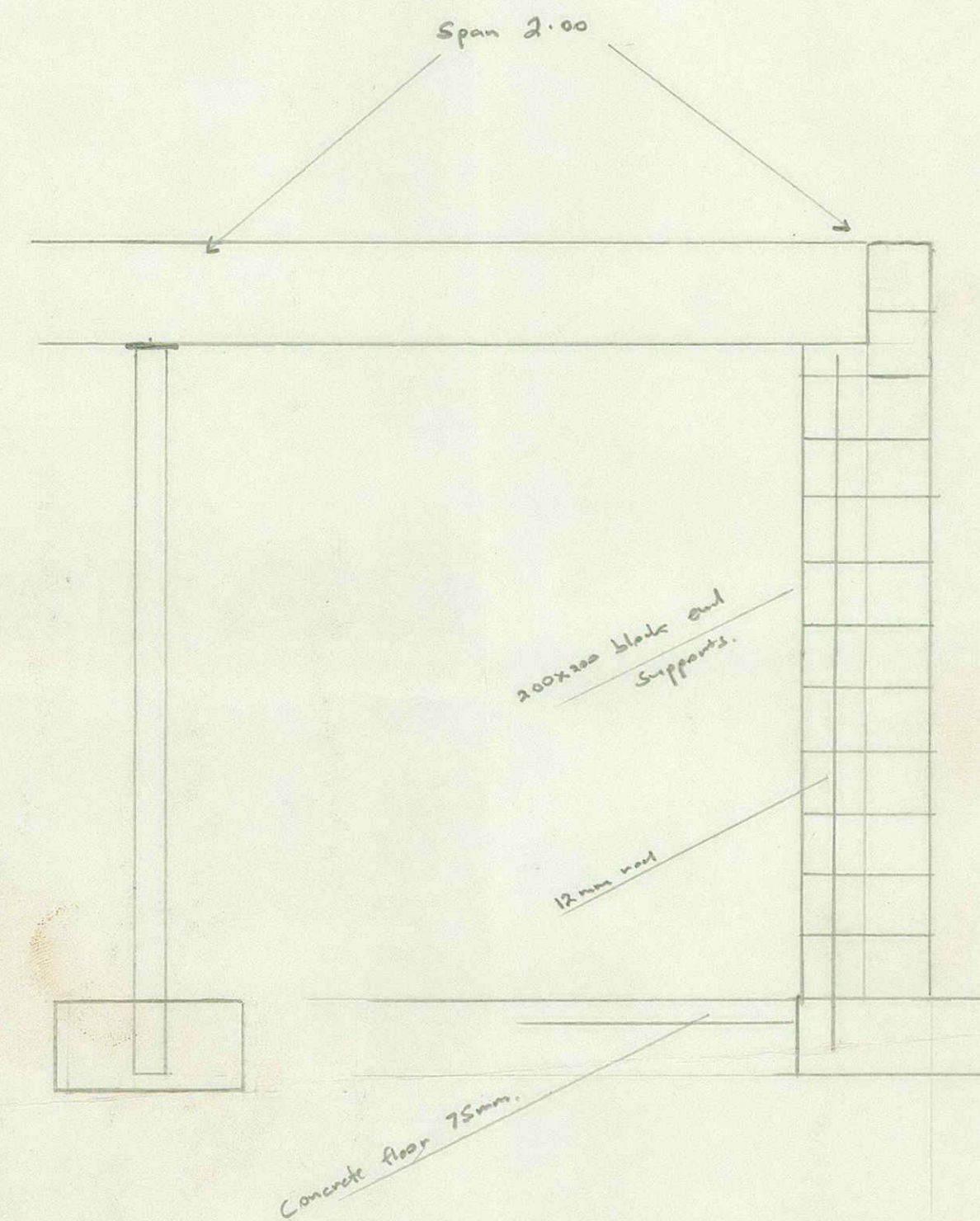
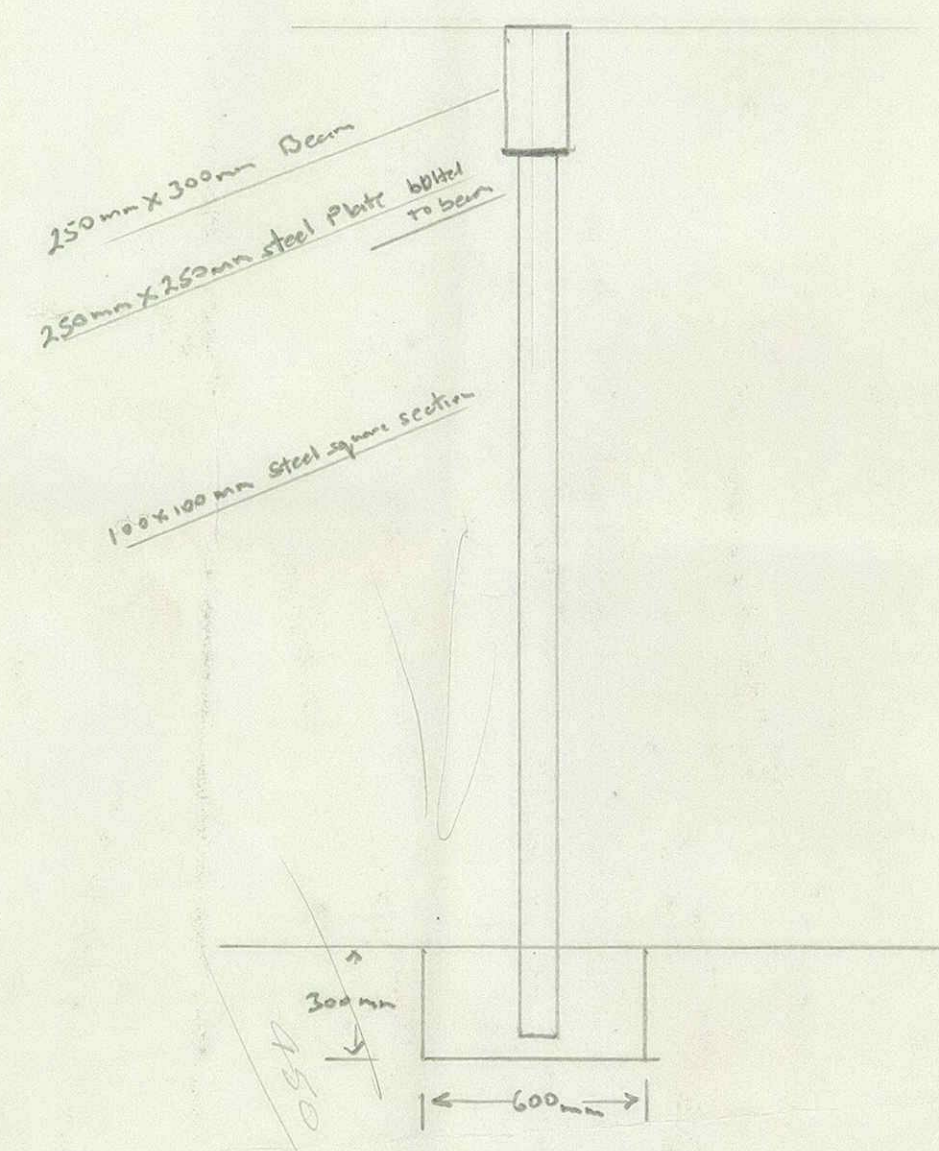
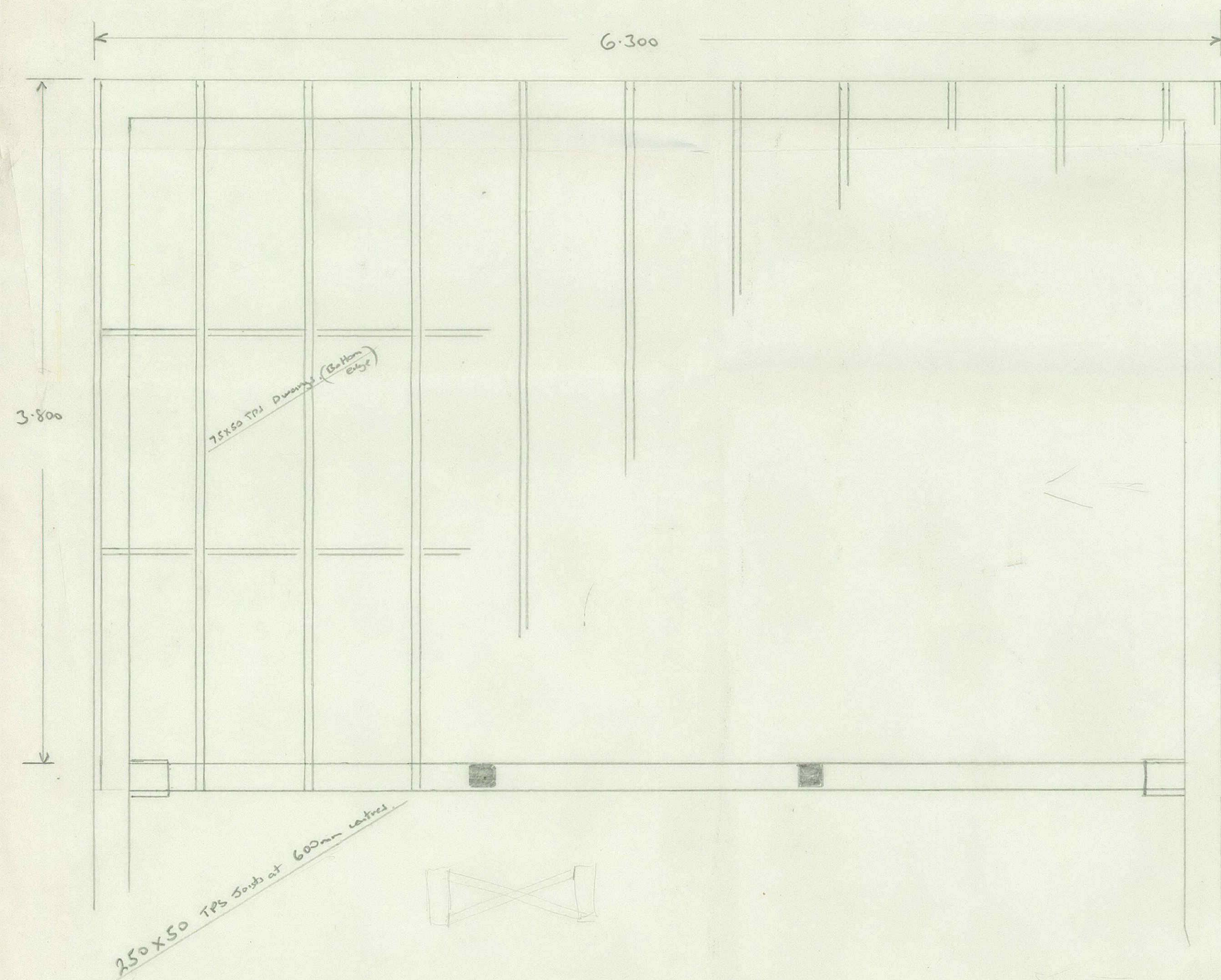
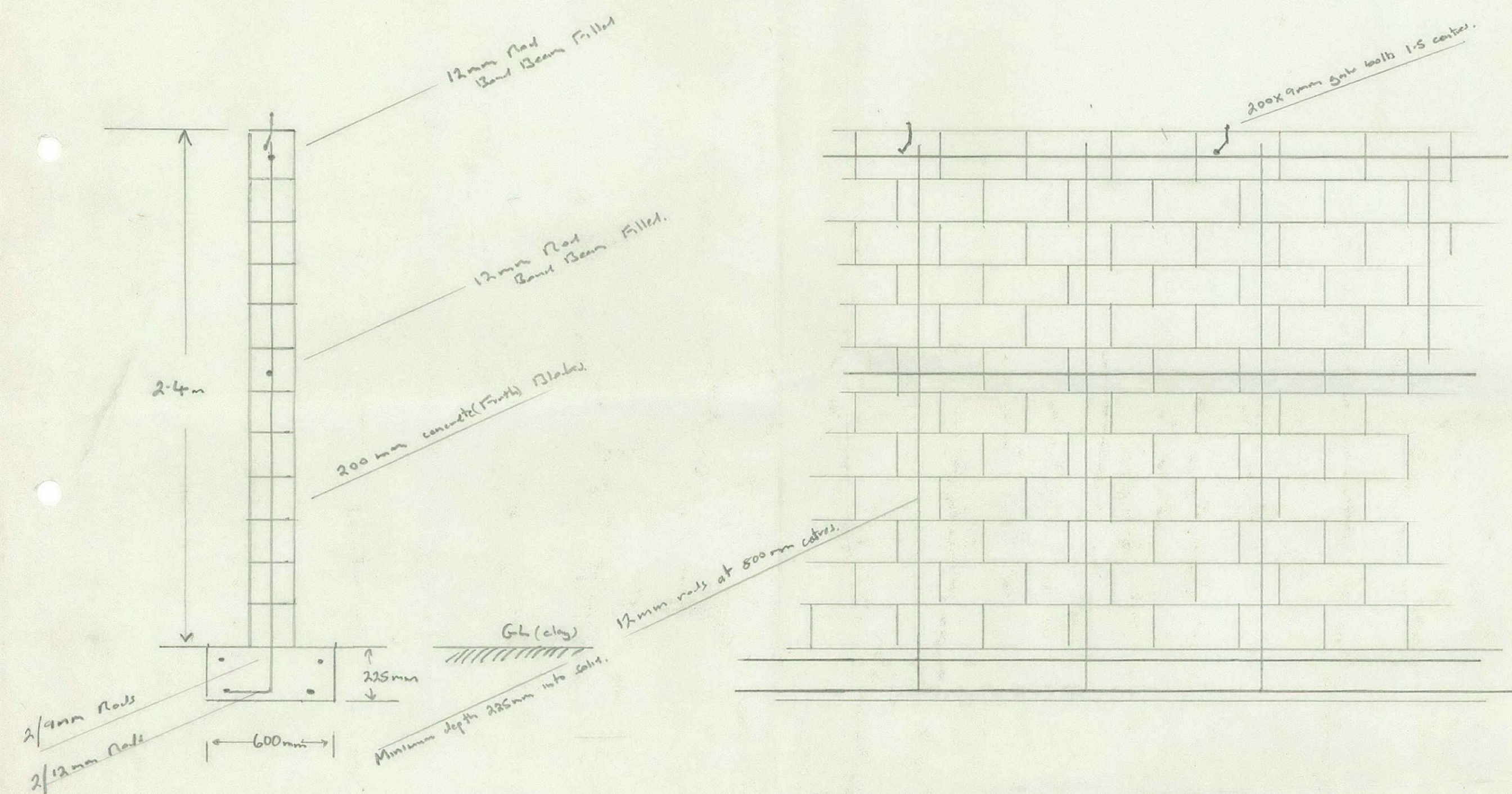

Notes to be 450 mm Centre
 Bridging at under
 Block supports to be tied to wall.
 Minimum foundation 300 mm